

Paul Yaffe's
Bagger
Nation™



SHARKNADO FAIRING
FAT BOB
INSTALL
INSTRUCTIONS



PAUL YAFFE ORIGINALS
DESIGN & DEVELOPMENT

1

2

3

4

ITEM NO.	Part Num	DESCRIPTION	QTY.
1	SGFB	Sharknado Glue-In Faring Bracket	1
2	SUMB-B	Black Sharknado Upper Mounting Bracket	1
3	SLFB-W	Sharknado Lower Faring Bracket Weld Assembly	1
4	HM-MS	Mini Shark Headlight Mount	1
5	SLMB-FB-B	Black FAT BOB Sharknado Lower Moveable Bracket	1
6	1/4-20 x 1 Zinc BH	Button Head Cap Screw	4
7	1/4 Zinc Flat Washer Type A (SAE)	Flat Washer	8
8	1/4-20 Nyloc Zinc	1/4-20 Zinc Nyloc Nut	4
9	5/16-18 x 1 Zinc BH	Button Head Cap Screw	3
10	5/16-18 Nyloc Nut	5/16-18 Zinc Nyloc Nut	7
11	5/16 Zinc Flat Washer Type A (SAE)	Flat Washer	16
12	5/16-18 x 0.75 Zinc HH Gr5	Hex Head	2
13	5/16-18 x 1.25 Zinc BH	Button Head Cap Screw	2
14	5/16-18 x 1 Zinc HH Gr5 Hex Head	Hex Head	2

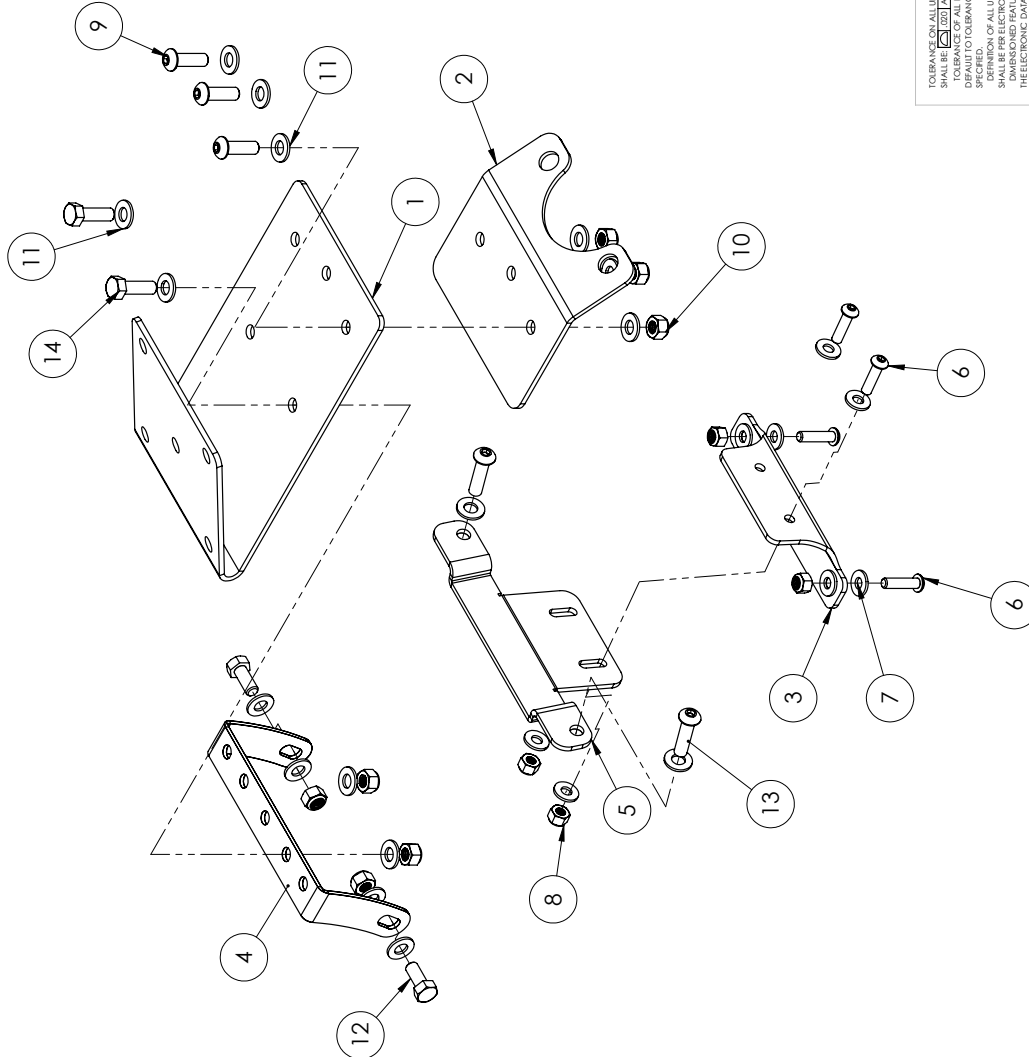

B

A

1

2

3

4

Paul Yaffe Bagger Nation

TITLE: Sharknado Fat Bob Bracket Kit

NAME: J.Eichman DATE: 5/11/2020

DRAWN: CHECKED: ENG APPR: MFG APPR: Q.A. COMMENTS: BREAK ALL SHARP EDGES .010-.020

UNLESS OTHERWISE SPECIFIED:
 TOLERANCES: FRACTIONAL ± 1/16 ANGULAR: MATCH ± 5°
 HOLE POSITION: ± 0.005
 HOLE SIZE: ± 0.005
 HOLE LOCATION: ± 0.005
 HOLE DRILL: ± 0.005
 HOLE TOLERANCE: ± 0.005
 HOLE FINISH: ± 0.005
 TOLERANCING PER: ANSI Y14.5

PROPERTY AND CONFIDENTIAL
 DRAWING IS THE SOLE PROPERTY OF PAUL YAFFE ORIGINALS AND PAUL YAFFE DESIGNS INC. ANY REPRODUCTION OR DISTRIBUTION OF THIS DRAWING WITHOUT THE WRITTEN PERMISSION OF PAUL YAFFE ORIGINALS AND PAUL YAFFE DESIGNS INC. IS PROHIBITED.

SCALE: 1:3 WEIGHT: SHEET 1 OF 1

REV: B

SUB-SFBKB

PART. NO.

B

A

Thank you for purchasing Paul Yaffe's Bagger Nation products. Please read through these installation tips completely before installing your Sharknado Fairing Kit.

1. Remove headlight nacelle by removing (2) bottom bolts. Pull nacelle down & out to remove. (Fig. 1)



2. Remove headlight & bracket assembly by unscrewing (3) screws from upper triple tree (unplug headlight connector) (Fig. 2)



3. Remove headlight mount bracket from headlight by unscrewing (2) side bolts (retain headlight). (Fig. 3)

4. Remove (2) nuts from bottom of handlebar risers. (Fig. 4)
5. Install upper Sharknado fairing support bracket onto (2) exposed riser bolts. Reinstall riser nuts & tighten fully

NOTE: Fairing support should be pointing at a slightly downward angle. (Fig. 6)



6. Using (2) 5/16 x 1 1/4 button heads and flat washers provided. Install part "A" of the lower Sharknado support bracket as shown in (Fig. 7) (Blue locktite) tighten fully.

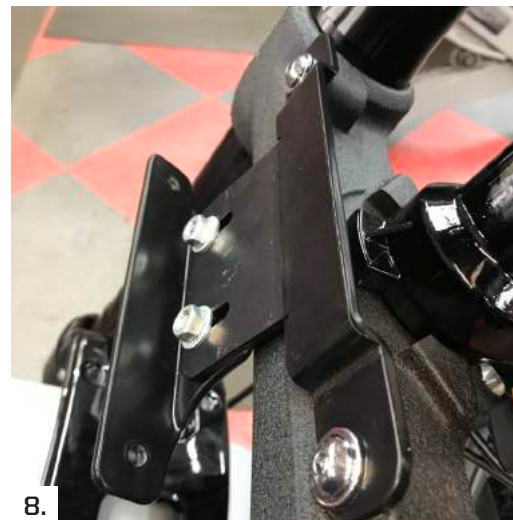

7. Using (4) 1/4" flatwashers and (2) 1/4" button heads and (2) 1/4" nylock nuts install part "B" of lower Sharknado support bracket shown in (Fig. 8)

NOTE: Lower bracket "B" sits "behind" lower bracket "A". Bottom head fasteners install from behind with nuts facing front of bike. Do not tighten at this time.



9.

You are now ready to install your Sharknado (Fig. 9)

8. Install Sharknado headlight support bracket on headlight as shown in (Fig. 10) using (2) 5/16 hex head bolts (4) 5/16 flat washers (2) 5/16 x 1" nylock nuts.

NOTE: Bracket will arch forward towards front of light. (Fig, 10) Finger tight only.



10.

9. Using (2) 5/16 hex head bolts (4) 5/16 flat washers (2) 5/16 nylock nuts install head light & bracket assembly into Sharknado fairing. Square bracket to fairing mount & tighten fully. (Fig. 11)



11.



10. Using (3) 5/16 button heads (6) 5/16 flatwashers (3) 5/16 nylock nuts, install Sharknado fairing on main upper support bracket.

Tip: With fairing tilted forward (Fig. 12 +13) and button heads inserted in fairing slide fairing over fork tubes below lower tree lift and roll into place.



Mount bolts will fall right through main upper support once aligned. (Fig. 14 + 15 + 16).

Use remaining (3) 5/16 flatwashers & nylock nuts to secure. Don't tighten at this time. (Fig. 17)



11. Using (2) 1/4" button heads (4) 1/4" flat washers (2) 1/4" nylock nuts bolt lowerer fairing support to fairing (Fig. 18).

Check fairing clearance to forks. Check Fairing alignment and that upper & lower mounts are resting square on fairing. There should be "no" or very little gap between mounting surfaces.

Fully tighten upper & lower fairing support at this time.



18.

12. Plug headlight lead in, find a wall that you can you can park your bike 25' away from. Put a mark (tape) 3' high on the wall. Measure 25' away and put your bikes front tire on that mark facing the wall.

Turn on your power (low beam) and adjust the headlight beam so that the middle of beam is hitting your 3' mark. Tighten your headlight fasteners (Fig #10).

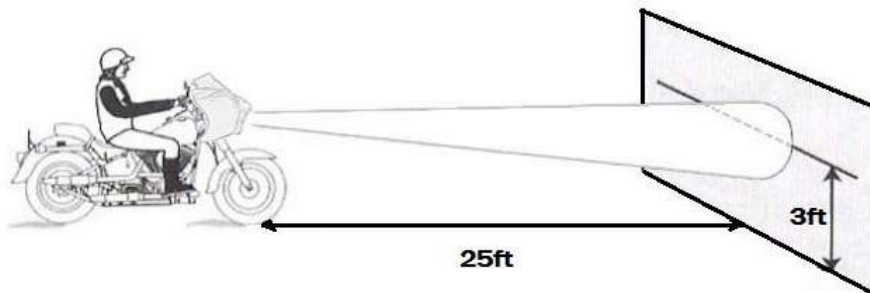

13. Install your Klock Werks Flare Windshield choice using the (4) 10x32 x.75" black screws provided with (4) black nylon flat washers on outside of windshield and secure with 10/32 black nylock nuts provided. (Fig #19)



19.



**SHARKNADO**
F A I R I N G

Paul Yaffé's
Bagger
Nation™

602.840.4205
BAGGERNATION.COM